

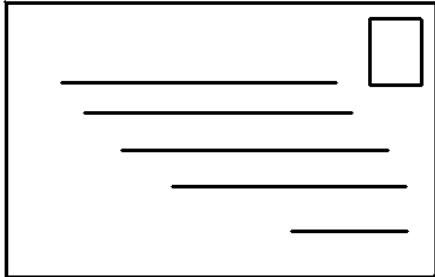

What we think about Pinewood & Hollywood

Easy read report

	<p>Address:</p> <p>Pinewood & Hollywood Smithsfield Colchester Essex CO1 2HP</p>
	<p>Date we did the inspection:</p> <p>26 March 2019</p>



Pinewood & Hollywood is a care home. When we visited, seven people with learning disabilities were living there.





About the Care Quality Commission



We are an organisation called the Care Quality Commission (CQC).

We checked to see whether the service given by Pinewood & Hollywood is safe, gives good results, caring, meets people's needs, and is managed well.

Here is what we found.



We ask five questions about services and this is what we found



Is the service safe?



We gave this service a score of 'good'.

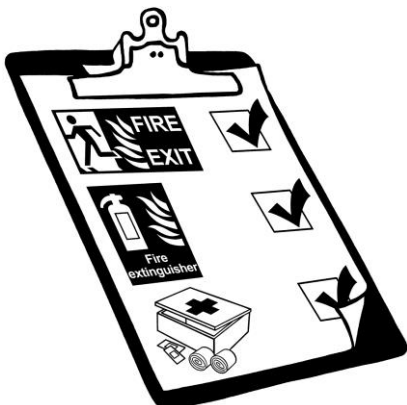

Staff knew how to keep people safe from harm.



Does the service give good results?



We gave this service a score of 'good'.



We saw that people were involved in decisions about their care.



Is the service caring?



We gave this service a score of 'good'.



Staff respected people's privacy.



People were involved in making choices about their care and support.



Does the service meet people's needs?



We gave this service a score of 'good'.

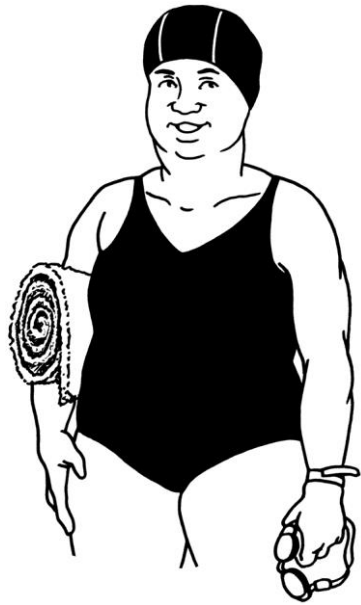

People were able to choose what activities they wanted to do.



People were helped to keep in touch with their families.



Is the service managed well?



We gave this service a score of 'good'.



People could say what they were happy with and what they were not happy with.

What happens next?



We have not asked this service to make any changes, but we will go back to check this again in the future.

Getting in contact with us



If you would like this report in another format or language, or you would like to tell us something, you can contact us at:

Phone: **03000 61 61 61**

Email: **enquiries@cqc.org.uk**